

All-in-one

Single-phase Energy Storage System

600W/2400Wh
800W/2400Wh
1000W/2400Wh



 Easy Installation  Integrated Design

BE200M8(B)-60(HC)FE
200 Watt

60 Half Cell Monocrystalline Module

FLEXIBLE

LINEAR PERFORMANCE WARRANTY

5 Year Product Warranty



Europe based aftersale service
Company HQ in Spain

CERTIFIED
IEC
61730 Ed.1

CERTIFIED
IEC
61215 Ed.2

 **Anti-PID**
System voltage durability
PPP 56042



Easy Plug-in

All-in-one design to make your home compact and aesthetic
Quick plug-in system, easy installation for everyone



User-friendly Scenario

Suitable for both on-grid and off-grid application
Support for both local LCD and remote APP control



Reliable Application

IP55 outdoor and indoor application
Low working temperature down to -15°C



Efficient System

PV system oversizing up to 2000W
6 work modes, 2 battery capacity choices



All-in-one

Single-phase Energy Storage System



Specifications are subject to change without advanced noticed.

Model	BXM 600/2400	BXM 800/2400	BXM 1000/2400
PV input			
Max. PV array power	2000 Wp	2000 Wp	2000 Wp
Max. input voltage	50 V		
MPP voltage range / rated input voltage	16 V to 50 V / 40 V		
Min. input voltage / start voltage	26 V / 30 V		
No.of independent MPPT trackers/ strings per MPPT input	2 / 2	2 / 2	2 / 2
Max. input current per MPPT tracker	28 A		
Max. short-circuit current per MPPT tracker	39 A		
Battery input			
Rated battery energy	2.4 kWh		
Rated capacity	50 Ah		
Battery type	LiFePO4		
AC output(On-grid)			
Nominal AC voltage	220V / 230V / 240V		
AC voltage range	154 V - 276 V		
Rated AC grid frequency	50 Hz / 60 Hz		
AC grid frequency range	45~55 Hz / 55~65 Hz		
Rated apparent power	600 VA	800 VA	1000 VA
Max. apparent power	600 VA	800 VA	1000 VA
Rated grid output current (@230 V)	2.6 A	3.5 A	4.4 A
Max. grid output current	2.8 A	3.8 A	4.8 A
Harmonics THDi (@ Nominal power)	< 3 % (of nominal power)		
AC input			
Rated grid voltage	220V / 230V / 240V		
Rated grid frequency	50 Hz / 60 Hz		
Max. input power from grid	1000 W		
Max. input current from grid	4.8 A		
AC output(off-grid)			
Nominal output voltage	230V		
Nominal output frequency	50 Hz / 60 Hz		
Rated apparent power	1000 VA		
Peak output apparent power	1600VA, 60 s		
Rated output current (@230 V)	4.4A		
Max. output current	4.8A		
Output THDv (@ Linear load)	< 2 %		
EPS model	Manual switch		
Efficiency			
MPPT efficiency	99.9 %		
Max.battery to load efficiency	92.0 %		
General data			
Power factor at rated power / adjustable range	1 / 0.8 leading to 0.8 lagging		
Topology	Isolated		
Dimensions (W / H / D)	600 / 400 / 310mm		
Weight	38 kg		
Operating temperature range	-15 °C ... +45 °C		
Cooling concept	Fan Cooling		
Degree of protection (as per IEC 60529)	IP55		
Max. relative humidity	95 %		
Max. operating altitude	3000 m		
Features			
User interface	LCD & App		
Zero-export interface	CT		
Internet communication interfaces	Wifi		
Certificates			
Grid	VDE 4105 / EN 50549/Type A, RD 647, UNE 217001, UNE 217002		
Safety	IEC/EN 62109-1, IEC/EN 62109-2		
EMC	IEC/EN 61000-6-1/-2/-3/-4, IEC/EN 61000-3-2/-3		
Battery	IEC62619, UN 38.3		



FLEXIBLE

BE200M8(B)-60(HC)FE

200 Watt

60 Half Cell Monocrystalline Module

DIMENSIONS

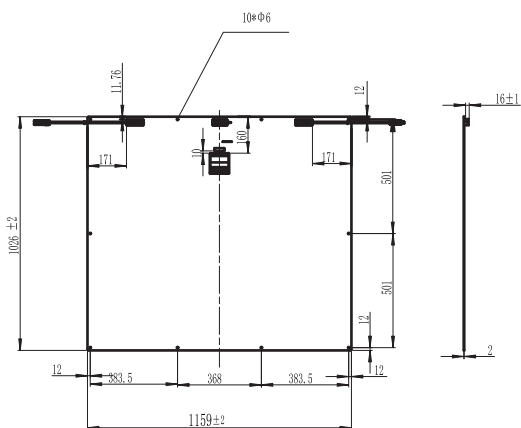

I-V CURVE (200)

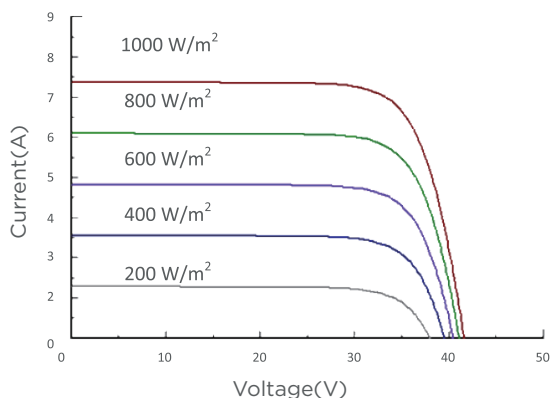

TEMPERATURE CHARACTERISTICS

Nominal Module Operating Temperature(NMOT) $41 \pm 2^\circ\text{C}$

Temperature Coefficient of Pmax $-0.34\% / ^\circ\text{C}$

Temperature Coefficient of Voc $-0.26\% / ^\circ\text{C}$

Temperature Coefficient of Isc $0.033\% / ^\circ\text{C}$

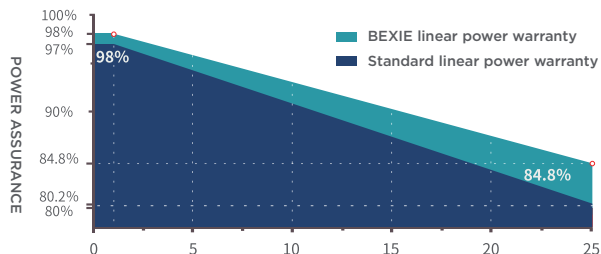

ELECTRICAL CHARACTERISTICS

BE200M8(B)-60(HC)FE

Maximum Power (Pmax)	200
Maximum Power Voltage (Vmp)	34.2
Maximum Power Current (Imp)	6.10
Open-circuit Voltage (Voc)	41.6
Short-circuit Current (Isc)	6.37
Module Efficiency (%)	16.9
Operating Temperature	-40 °C to 85 °C
Maximum System Voltage	1500 V DC (IEC)
Maximum Series Fuse Rating	25 A
Application Class	Class A
Power Tolerance	0/+5 W

STC: Irradiance 1000W/m², Cell temperature 25 °C, AM=1.5.

Tolerances of Pmax, Voc and Isc are within $\pm 5\%$

BE200M8(B)-60(HC)FE

Maximum Power (Pmax)	162.3
Maximum Power Voltage (Vmp)	34.2
Maximum Power Current (Imp)	4.75
Open-circuit Voltage (Voc)	41.7
Short-circuit Current (Isc)	5.09

NMOT: Irradiance 800W/m², Ambient temperature 20°C, AM=1.5, Wind speed 1 m/s.

MECHANICAL CHARACTERISTICS

Solar Cell	Monocrystalline silicon (182mm half cell)
No. of Cells	60(6x10)
Module Dimensions	1159x1026x2 mm
Weight	2.6kg
Backsheet	cell side Black
Frame	Frameless
J-box	IP 68 rated
Output Cables	Photovoltaic technology cable 4.0mm ² , (+)450/(-)450mm
Connector	MC4 compatible

PACKAGING CONFIGURATION

Container size	20Ft	40Ft
Module per pallet	66	66
Pieces per container	1056	2112

+34 985 194 232

CALLE COVADONGA 5, 33002 (OVIEDO, ASTURIAS)

www.bexiegroup.com